

Qi Coil™ Frequencies Quick Start Guide

How to Use the Frequencies:

1. You can just listen without Qi Coils.
2. You can use the Qi Coils without listening for PEMF Therapy.
3. You can use the Qi Coils while listening to the sound through headphones or a speaker.

How to Access Qi Coil™ Frequencies – Web App or Console

Frequency Sources

You can access the frequencies through the Qi Coil™ Web App or a Qi Coil™ Console tablet. Both of these allow you to filter through and play the various frequencies by categories and frequency intensity level. You can also save specific frequencies as favorites, so you don't have to search for them again. You can even build a personal customized playlist of individual frequencies.

Both the console and the web app also have an extended menu of information where you can find tutorials, training videos, testimonials, links to the Qi Life Store, and customer service.

The Web App

Anyone can access the Basic Frequencies for FREE by going to <https://members.qicoil.com/> and JOIN NOW. Add an email address and password to join as a member and get the Basic Frequencies.

The Web App on a computer or Tablet

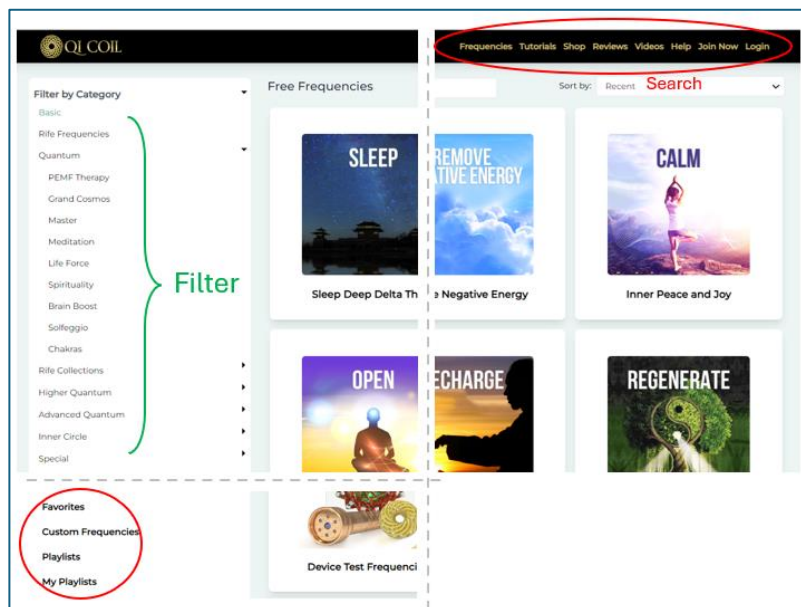

The Web App on a Phone

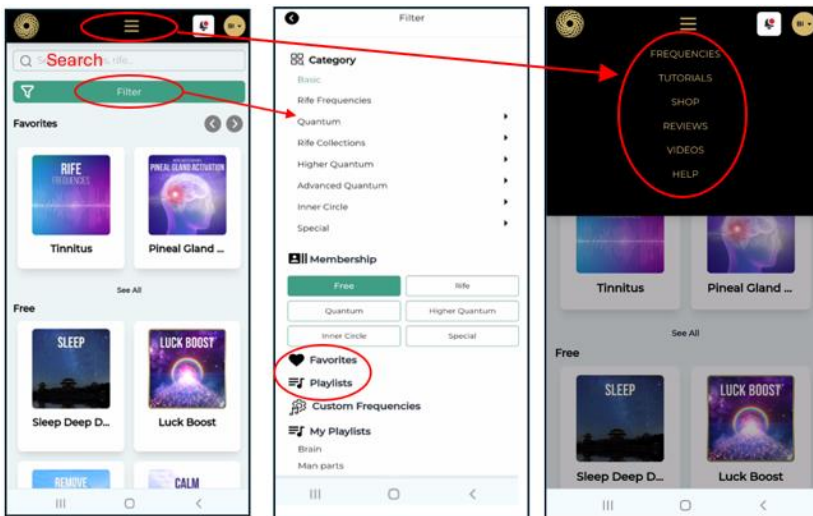

The Console

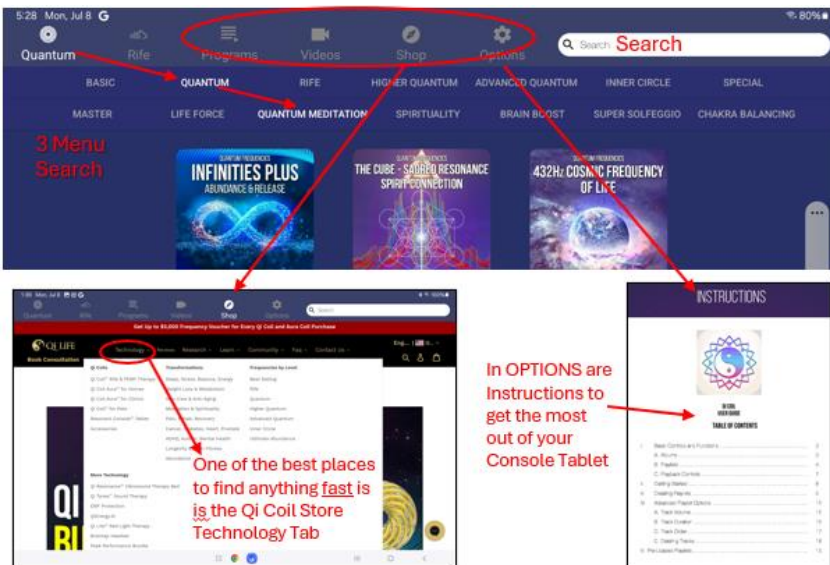

The Console uses a 3-tier menu.

Rife frequencies can be searched by name or condition.

The extra menu items are across the top.

Under 'Options' the Console has an instruction section about how to best use and get the most out of the tablet

NOTE:

Each menu has a links to the Qi Life Store. The Technology Section in the store is one of the best and fastest way to find information.

Playing Frequencies

Single or Replay

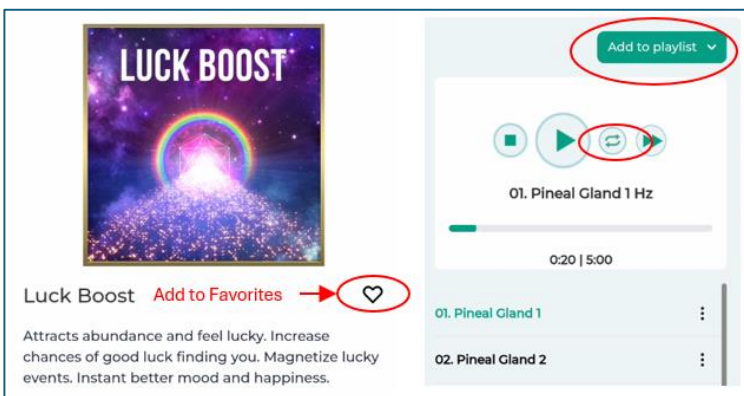

All of the source devices basically work the same. You can search for any frequency and start to play it.

- Press the play button to start playing the frequency.
- By default, the frequency will keep playing on repeat. If you want to stop it from repeating, look for the button next to the play button that says "repeat." Tap it once to stop the frequency from repeating after it finishes playing. - it will turn gray in color to indicate that the current frequency will no longer repeat after it finishes playing.
- If you want to start repeating the frequency again, tap the repeat button again. You should see the button change color to let you know that the frequency will now play on repeat again. You have the option to replay just one track or the whole program. In the console, you will see a small 1 to indicate you are going to repeat it once.



Favorite

Once you find a frequency you like you can save it in favorites by clicking on the heart next to the frequency. Go to the favorites menu and it will be there.



Custom Play list

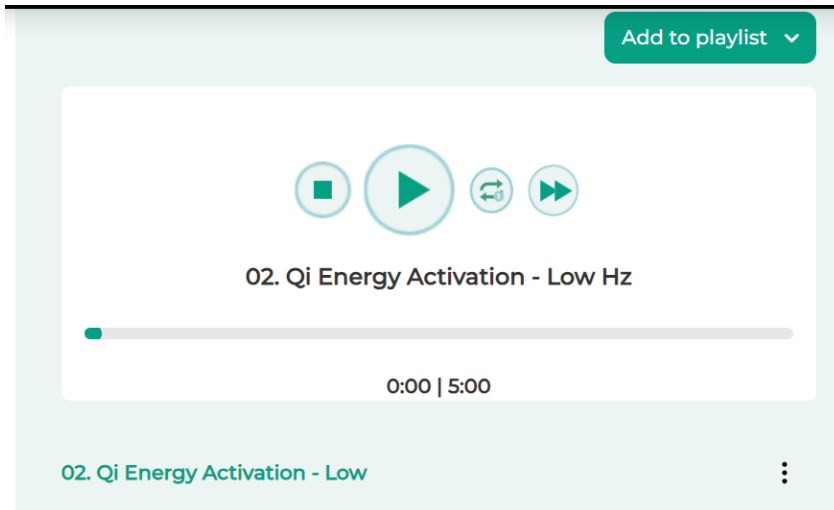





- Playlists are great because you can mix and match the frequencies you want to hear.
- To start, you will need to create a playlist. There are a couple of ways to do this. When you log in to your account online, navigate to your desired program (list of frequencies). Click on the Add to Playlist button. From here, click on Create Playlist. You can also go to the home screen and scroll down to "My Playlists" and create one from there.
- Once you have created a playlist, you can add any frequencies to it. Go back to the frequencies you want to add to your playlist and add it, using the same button as before. **Note: You cannot add a program, but you can add a track to your playlist.**
- If you are using the console, you can do all this with the 3-dotted button icon. Click "Add to Playlist" and then you should be able to see the name of the Playlist you recently created. Tap the playlist name and it will notify you that the frequency has been added to the playlist.
- To check on your Playlist. Go back to the main menu. Then press "Playlist", you should be able to see the playlist you created.
- To delete an album in your playlist. Press the red "X" button on the album's right side. Confirm the deletion by pressing "Ok".
- To delete the playlist, press the yellow "Delete" button on the top of the playlist.

What Frequencies Do I Have?

Depending on your purchase, you will receive different levels of frequencies. If you purchased the Mini (no console) or Console 1, you receive the Basic and the Rife frequencies.

Consoles 2, 3, Advanced or Ultimate have added frequencies according to the Chart below.

Whichever frequencies that come with your console will be added to the Web App within 24 to 48 hours so that any of the devices can access all the frequencies.

					
Main Feature	10,000+ Dr. Rife's original frequencies	Sacred Geometry Frequencies for Mind & Body Wellness	Powerful Frequencies for Personal Transformation	Advanced Frequencies for Personal Transformation	Most Powerful Frequencies to Unlock Your Human Potential & Abundance
10,000+ Rife Frequencies	✓	✓	✓	✓	✓
1038 Quantum Frequencies	✗	✓	✓	✓	✓
647 Higher Quantum Frequencies	✗	✗	✓	✓	✓
414 Advanced Quantum Frequencies	✗	✗	✗	✓	✓

How to Subscribe for More Frequencies

- When you log in to your account, navigate to any of your locked frequencies. Then tap to press. There's a tiny white lock icon in the lower right corner of the album.)
- You'll see the UNLOCK button below the play bar. Tap the button.
- Choose your payment plan. Then fill out the payment details.
- Once filled out. Tap on the subscribe button. Wait for the confirmation.
- Once payment successfully goes through. You'll be able to play the unlocked frequencies under the subscription you availed.